

Zellofant M95 Insulation Blowing Machine



- ▶ Reliability and Power in a Compact Design
- ▶ Compatible with Numerous Insulation Materials
- ▶ Precise Controlling Options
- ▶ Efficient and Powerful
- ▶ Compact and Mobile



Air generation with up to three high-performance radial compressors



Functional Principle and Standard Equipment



The insulation bales are laid on the support for bags (optional), opened and pushed into the hopper.

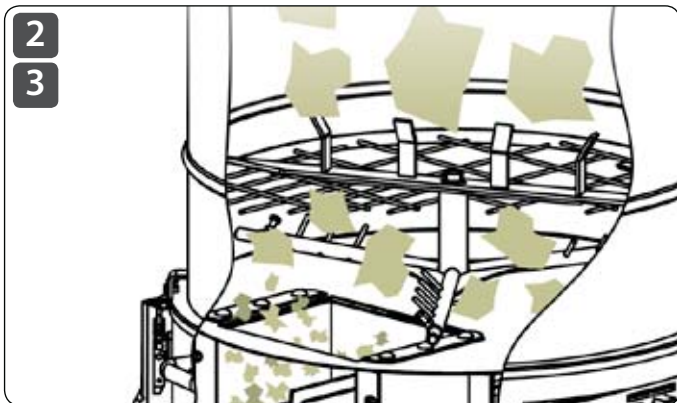

The rotating shredder disaggregates the material in smaller pieces. The replaceable grid only allows small pieces to fall into the rake unit. The rake unit conditions the material ready for blowing.



Airlock Feed Gate

The manual airlock feed gate (optional) makes a material flow volume control possible. It can be adjusted precisely by hand in 14 levels.

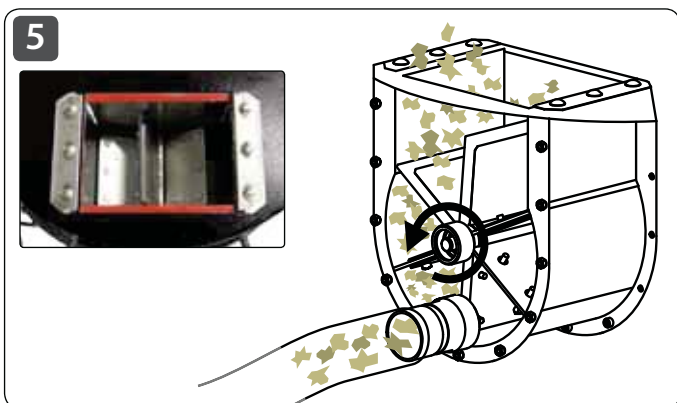

The cellular wheel transports the material to the lower part of the airlock. The air flow of the high-powered radial compressors accelerates the material and forwards it through the airlock outlet into the conveyor line.

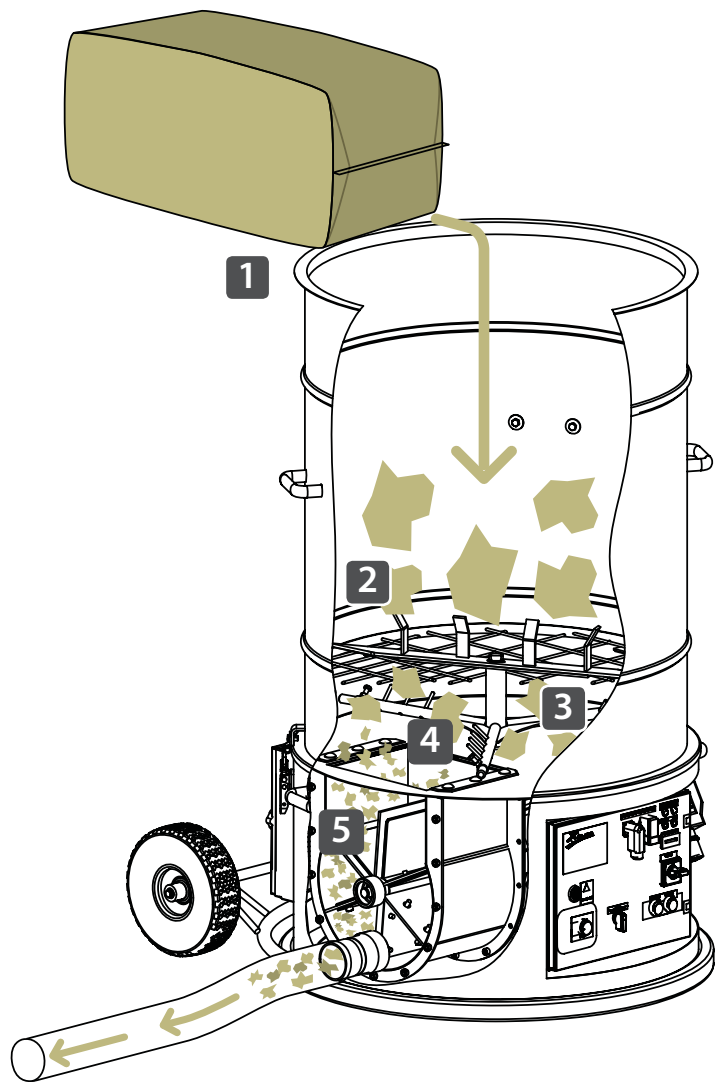

Airlock Ventilation

Increases significantly the airlock's efficiency and prevents actively from dust turbulences in the filling hopper.

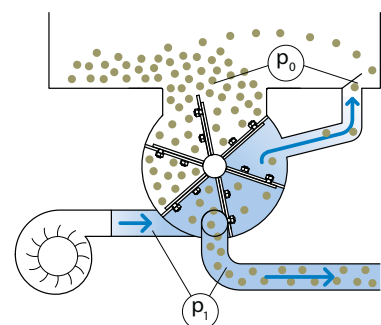

Ergonomic loading:

- ▶ Sack support for bags for simplified filling and opening of insulation materials
- ▶ Dust-reducing cover with passive and active dust-extraction for low-dust filling
- ▶ Shorter hopper can be used in conjunction with a dust-reducing cover



Machine Control

- ▶ Robust casing, clear LED indicator and simple controls
- ▶ Toggle function for conveying with and without material
- ▶ Material- and air volume regulation
- ▶ Activation of pressure control programs
- ▶ Audible warning signals



Optional Shredder:

- ▶ Improved fibre conditioning for highly compacted materials.
- ▶ Higher processing speeds with conventional insulation materials.
- ▶ Optimal fine conditioning for spray-on applications. Art.-Nr. 3251



Improved Agitator

The Rotating Shredder Arm breaks the bales into smaller pieces.

The Replaceable Grid only allows small pieces to fall into the rake unit.

The Rake Unit conditions the material ready for blowing.

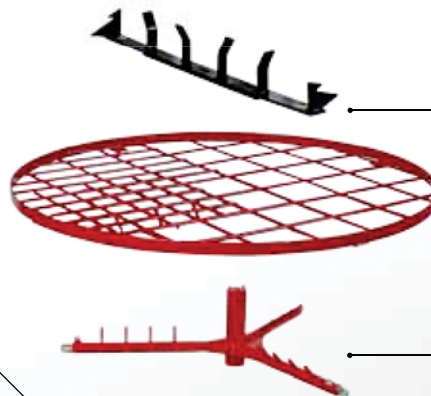

Optional Airlock Feed Gate:

- ▶ Improved fine adjustment and regularity of the material flow volume
- ▶ Recommended for spray-on applications and cavity wall insulation

Art.-Nr. 3194



Incoming Air Filter
The fast removable suction hood allows an easy cleaning of the air filter elements.



Optional Outlet Console NW90:

This upgrade is suitable for all Zellofant airlocks. The outlet console has a NW90 (3 1/2") thread connection and a NW90 (3 1/2") socket which allows an increase of the material flow by more than 20%.

Compact Machine Base:

- ▶ Clearly arranged operating elements
- ▶ Easily accessible connection points
- ▶ Easy maintenance



Zellofant M95: Efficient- and Powerful

Mobility

The Zellofant M95 is a compact and mobile insulation blowing machine. Due to its little weight and its wheels, the Zellofant can be ranged easily on rough building site ground.



Feeding

The Zellofant M95 is easy to fill. When filling the machine, the ergonomic support for bags (optional) allows a comfortable positioning of the insulating material.



Configuration Options



Support for Bags

Description	Prod.No.
Support for bags	4791
Support for bags with dust-reducing cover	3218
Support for bags with dust extraction attachment (material: wood)	5786



Reinforced Rotary Airlock

Description	Prod.-No.
Reinforced Rotary Airlock L200	6719
Reinforced Rotary Airlock L230, 1x63mm	6726
Reinforced Rotary Airlock L230 2x50 mm	6725



Short Hopper Top Piece

Shorter hopper top piece, facilitates filling of the machine.

Prod.No. 4812



Extension NW75>90

Extension Tube NW75>90
The Zellofant M95 can be equipped with an extension tube which enables an outlet from NW75 to NW90.

Prod.No. 6746



Deflection Element Universal

Deflection element for fastening to the hopper's inner side. A fine zigzag structure enables a good ripping of the insulation material and compacted pieces of material, which won't be broken completely, will be conditioned.

Art.-Nr. 8358



Upgrade Airlock NW90

This upgrade is available for all Zellofant airlocks. The outlet console has a NW90 (3 1/2") thread connection and a NW90 (3 1/2") socket.

Prod.No. 7109

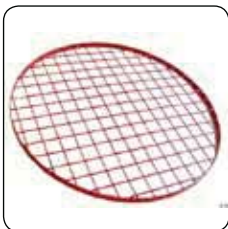

Retention Grid for Hopper

The retention grid is intended for processing loose bulkware as EPS granules.

Prod.No. 2941



FFB2000-Pro

The radio remote control FFB2000-Pro in a robust casing increases the free moving space. It has bidirectional radio technology with a high transmission reliability and four radio channels. When required, it can also be used with a cable connection.

Prod.No. 5154

Amplification

In case of large conveying heights, long conveyor lines or strongly compacted insulation materials, the Zellofant M95 can be connected with an amplifier. This way, the machine receives an increased air performance.



Dust Extraction + Extraction

With the dust-reducing cover, an amplifier/vacuum station and a suction drum, the operator can work comfortably and material residues can be reduced.



Dimensions

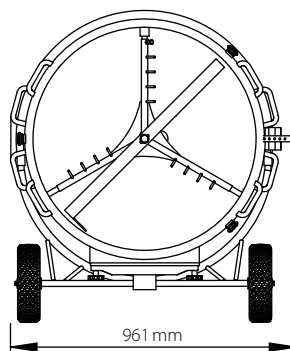
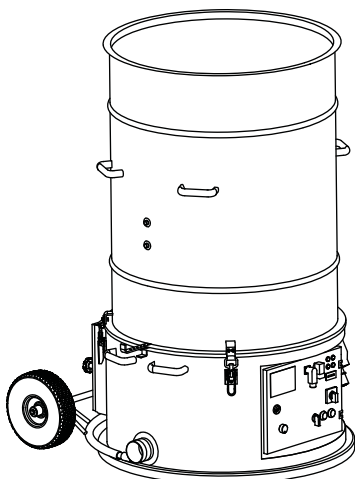
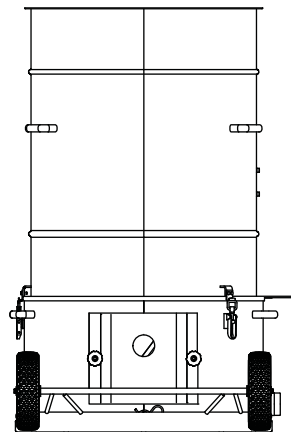
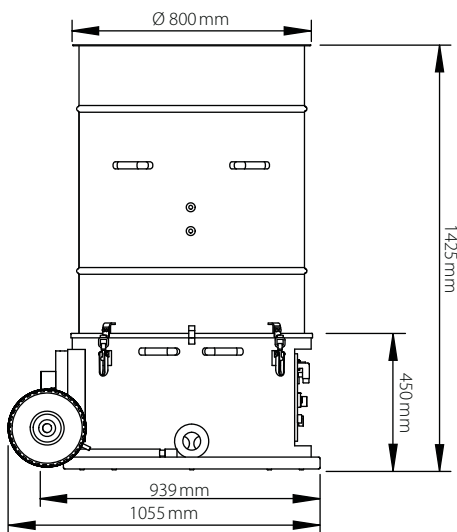

Blowing Injection Processes

Different architectural styles and construction designs require variable methods in the blowing injection processes. We distinguish four different methods. The Zellofant M95 is an all-round solution for medium-sized projects.

In the following we show the various blowing injection methods and give an overview of the recommended applications in our comparison matrix.

Open Blowing

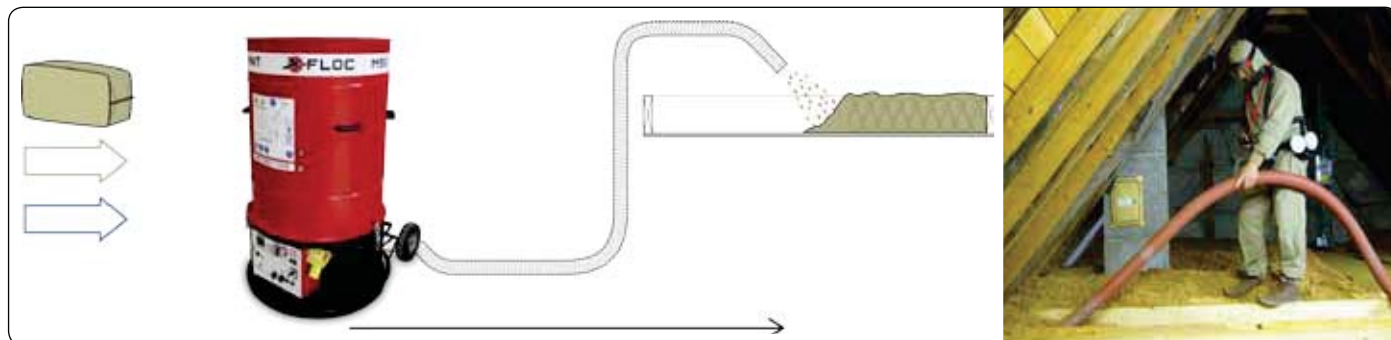

Dry Injection

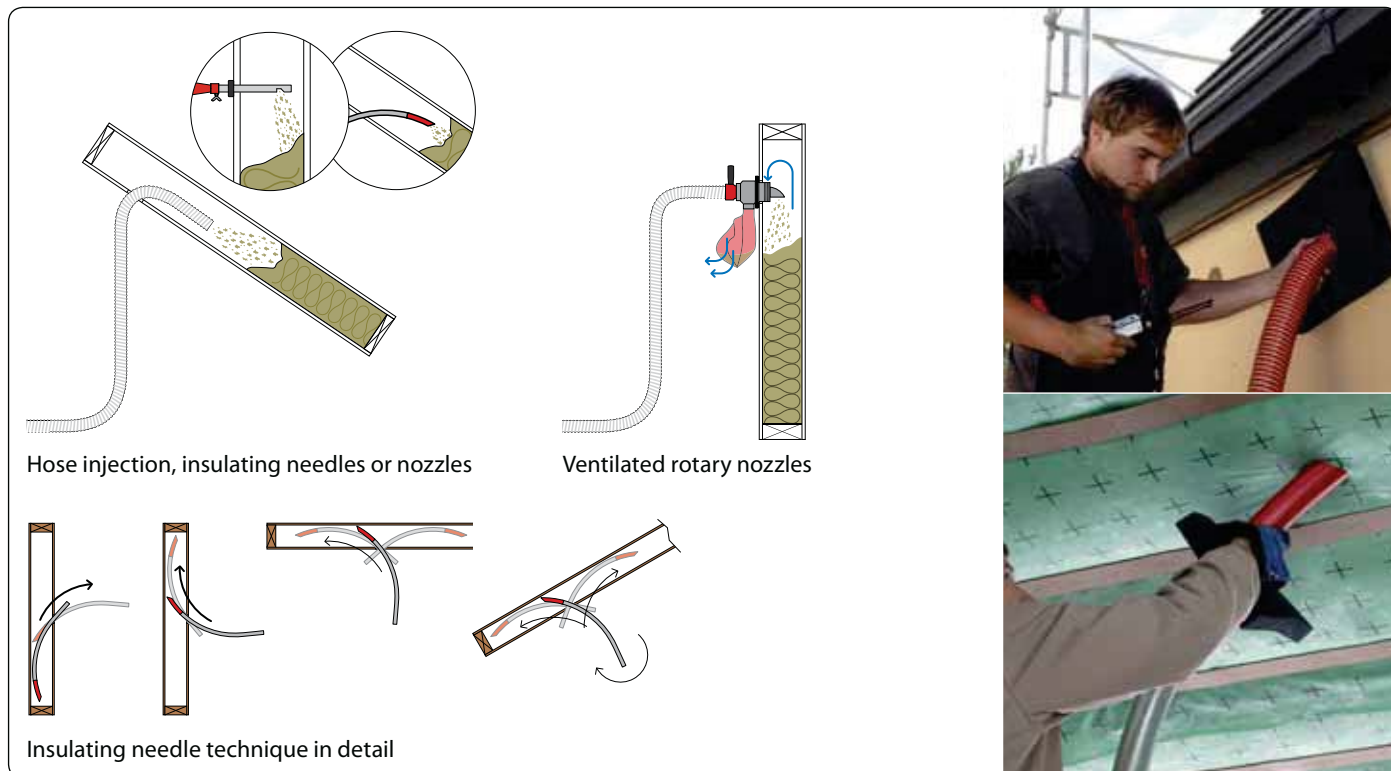

Damp Spray / CSO / Fire protection

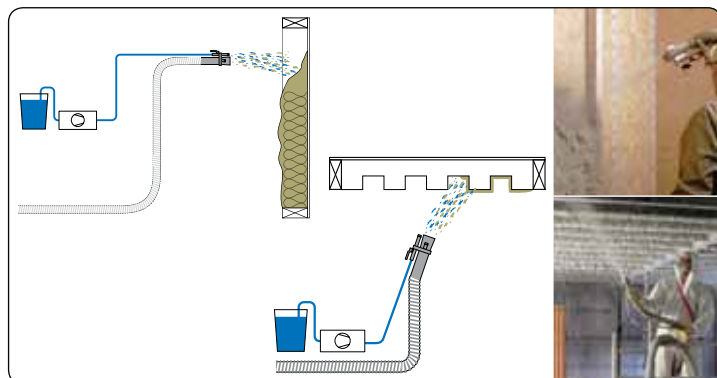

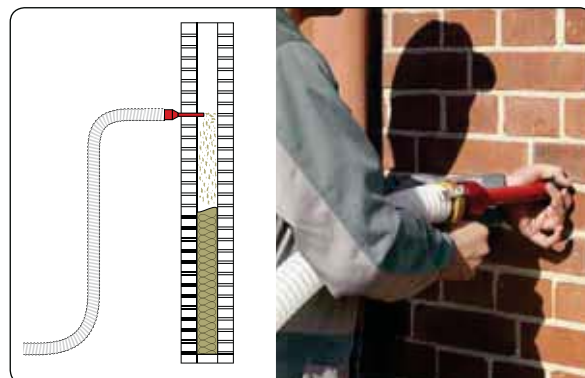

Cavity Wall Insulation



Comparison Matrix



		Zellofant M95-230V/3,7 kW						Zellofant M95-2x230V/5,1 kW						Zellofant M95-400V/5,5 kW Zellofant M95-400V/7,0 kW (7,3 kW)					
Machine model		M95-3,7kW						M95-5,1kW						M95-7,0kW					
Images																			
Cellulose	Applications	A	B	C	D	E	F	A	B	C	D	E	F	A	B	C	D	E	F
	Suitability	1	1	1	2	1		1	1	1	2	1		1	1	1	2	1	
Examples *1) Advanced Fibre cellulose, AislaNat, Applegate, Arbocel Climasafe, Arctic Fiber, Austrozell, Bellouate, Biocell, Biofib Isolation, Cellaouate, Cellisol, Cel-Pak, Climacell, Climate-Super, Climatizer Plus, Dämmstatt, EC cellulose, Ecocel, Ekofiber, Ecovata, Dobry Ekovilla, Fiberlite, Finefloc, Forest wool, Franceouate, Greenfiber, Klima-Tec-Flock, iCell, Igloo, Iglu, Isocell, Isodan CI 040, Isofiber, Isofloc L, Isofloc LW, Isoprof, Isol'quate, Mono-Therm, Northern Fiber, Nesocell, Nu-Wool, Ouateco, Pavafloc, Poesis-Floc, Quateco, Renocell, Selluvilla, Termex, Thermofloc, United Fibers, Unifloc, Univercell, Wolfinger Dämmzellulose etc.																			
Wood fibre	Applications	A	B	C	D	E	F	A	B	C	D	E	F	A	B	C	D	E	F
	Suitability	2	3	3		4		1*2)	2*2)	2*2)		3*2)		1*2)	1*2)	1*2)		2*2)	
Examples *1) Agricell, Airflex, Hoiz, KKS Woodfiber, KKS Woodfiber Granulate, Jasmin, Neptutherm, Steicozell, Thermofibre, Thermocell, Termoträ, Woodycell etc.																			
Mineral fibre	Applications	A	B	C	D	E	F	A	B	C	D	E	F	A	B	C	D	E	F
	Suitability	3	3	3	3	3		1	2	2	3	2		1	1	1	3	2	
Examples *1) Astratherm, Climastone, Comblissimo, Ecofibre (BLT3 – BLT5 – BLT9), Ecofibre KD, Fibrexpan, Greenguard, Indi-Flock, Insulsafe, Inslusafe Plus, Insuver, ISG, Isolene 4, Isomat, Paroc BLT7, Projiso, Rathiflock, Rockwool, Supafil cavity wall, Supafil loft, Supafil timber frame, Thermacoustic TC-417, Teko-Flock etc.																			
Mineral granules	Applications	A	B	C	D	E	F	A	B	C	D	E	F	A	B	C	D	E	F
	Suitability	1				3	1	1				3	1	1				3	1
Examples *1) Bachl Perlite, Extraperl H4, Fillrock KD, Hyperdämm, Hyperlite, Isomat ISG, Liapor, Perlifill-F, Perli-Fill, SLS20, Thermofill S – S40, Thermoperl etc.																			
EPS granules	Applications	A	B	C	D	E	F	A	B	C	D	E	F	A	B	C	D	E	F
	Suitability					1						1						1	
Examples *1) Bodiflock XPS, DämmPerl 035, Durolan, Duoperl 35, EASY-FILL 034 – 033, Granublow 035, HK35, HK33, H2 Wall, Joma Perl, Neopor, Rigibead, Rathipur KD etc.																			

Legend Suitability

1 Extremely well suited / Best machine choice 2 Well suited 3 Recommended with limitations 4 Not recommended

*1) These examples do not lay any claim to being complete. Is your product listed? If not, please contact us.



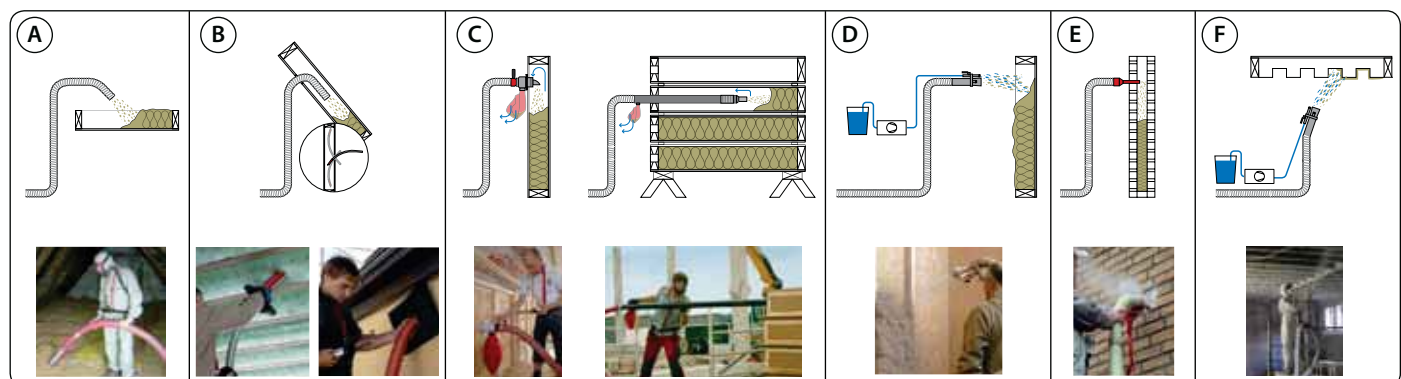

*2) Amplifier recommended.

Applications

A: Open/attic blowing · B: Dry injection · C: Dry Injection with ventilation · D: Damp spray/CSO · E: Cavity wall insulation · F: Fire protection



Technical Data

Model	Zellofant M95			
Machine type	M95-230V/3.7kW	M95-2x230V/5.1kW	M95-400V/5.5kW	M95-400V/7.0kW (7.3kW)
Images				
Product number	7139	6906	6907	6908
Power/material processing speed ^{*1)} (max.)	650 kg/h	750 kg/h	850 kg/h	1080 kg/h (1255 kg/h)
Hopper	0.44 m ³ (Short hopper 0.3 m ³)			
Airlock outlet Ø	NW75 (3") or NW90 (3 ½") ^{*2)}			
Dimensions (L×W×H)	Ø 800 × 1425 mm			
Unladen weight	155 kg	160 kg	165 kg	185 kg
Filling height	1425 mm			
Airlock ventilation	✓			
Dust removal/support for bag	✓ Support for bags with dust reducing cover (optional)			
Machine control	KFB2000/FFB2000-Pro			
Material conditioning	✓ 2-level agitator with rotating shredder arm, replaceable grid and rake unit			
Shredder	✓ (Optional)			
Airlock feed gate	✓ 14 positions, manual adjustment (optional)			
Adjustable airlock rotational speed	✓ 10 levels (KFB2000) ✓ 19 levels (FFB2000-Pro)			
Air feed unit	2 High-powered radial compressors	2 High-powered radial compressors	2 High-powered radial compressors	3 High-powered radial compressors
Air flow volume (nominal/measured)	320/250 m ³ /h	390/370 m ³ /h	390/370 m ³ /h	590/540 m ³ /h
Conveying pressure max. (adjustable)	300 mbar	375 mbar	390 mbar	400 mbar
Conveying height ¹⁾ without/with amplifier (max.)	>45 / >70 m	30 / >70 m	30 / >70 m	33 / >70 m
Installed air power (adjustable)	2 × 1.2 kW	2 × 1.8 kW	2 × 1.8 kW	2 × 1.8 + 1.45 kW
Installed motor power	1.3 kW	1.5 kW	1.85 kW	1.85 kW
Power rating	3.7 kW	5.1 kW	5.5 kW	7.0 kW (Optional 7.3 kW)
Power supply	230V / 50Hz / 16 A ^{*3)}	2 × 230V / 50Hz / 16 A ^{*3)}	400V / 50Hz / 3×16 A	
Material packing density(max.)	155 kg/m ³	165 kg/m ³	165 kg/m ³	

All values approximate.

*1) Depending on use, material and delivery · *2) Direct reduction to NW50 (2") possible · *3) Operation with 230V / 10 A / 50Hz with reduced air power possible.

Characteristic curves at 50 Hz

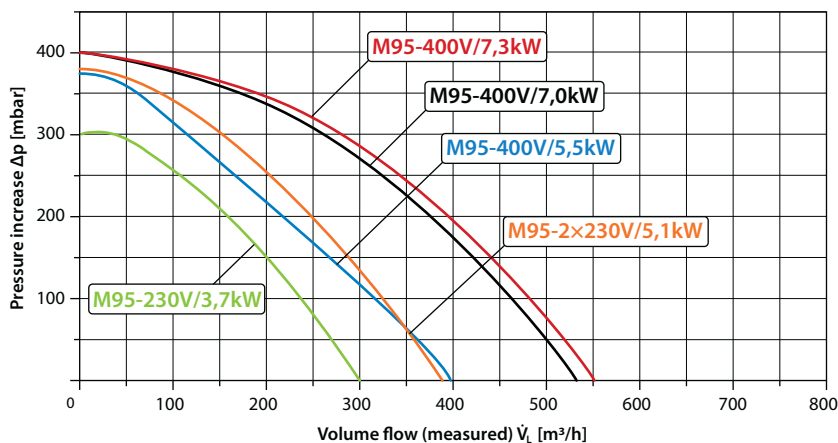



- Contents**
- ▶ One remote with carrying strap
 - ▶ One charger
 - ▶ One receiver with magnet
 - ▶ Two antennas
 - ▶ Quick start guide
 - ▶ Complete foam lined case



The FFB2000-Pro combines the possibilities and advantages of modern digital technology for the insulation pro. All important machine settings for the insulation blowing process can be controlled by the radio remote control.

The FFB2000-Pro is compatible with the insulation blowing machines M99-DS-Pro, M95, EM300, EM400/440 and EM500.

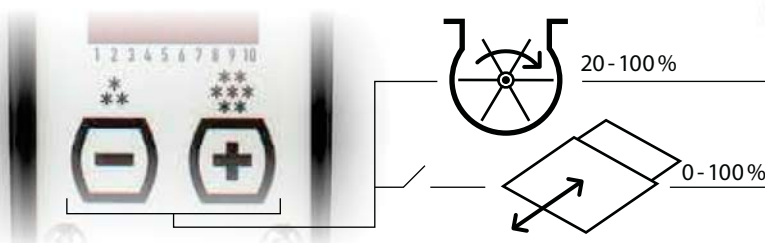

Material flow volume control: Optional airlock rotational speed or electrical airlock feed gate (as from EM300 type possible)

Features:

- ▶ High transmission reliability
- ▶ Individual adjustments
- ▶ Bright adjustment display
- ▶ Light but robust control
- ▶ Air power adjustable in 19 levels (20...100 %)
- ▶ Material flow with airlock feed gate adjustable in 19 levels (0...100 %)
- ▶ Material flow with airlock speed adjustable in 19 levels (20...100 %)
- ▶ Dynamic shutdown and dynamic pressure
- ▶ Supplied in a practical suitcase

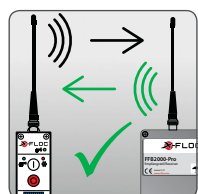

Bidirectional digital radio technology



Four radio channels for interferences on building sites



Compatible with X-Floc and other machines

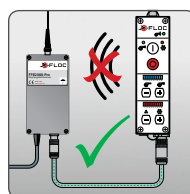

Cable connection possible

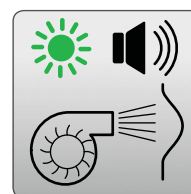

Optical and acoustic alarm for overpressure



Standard rechargeable batteries in the remote control

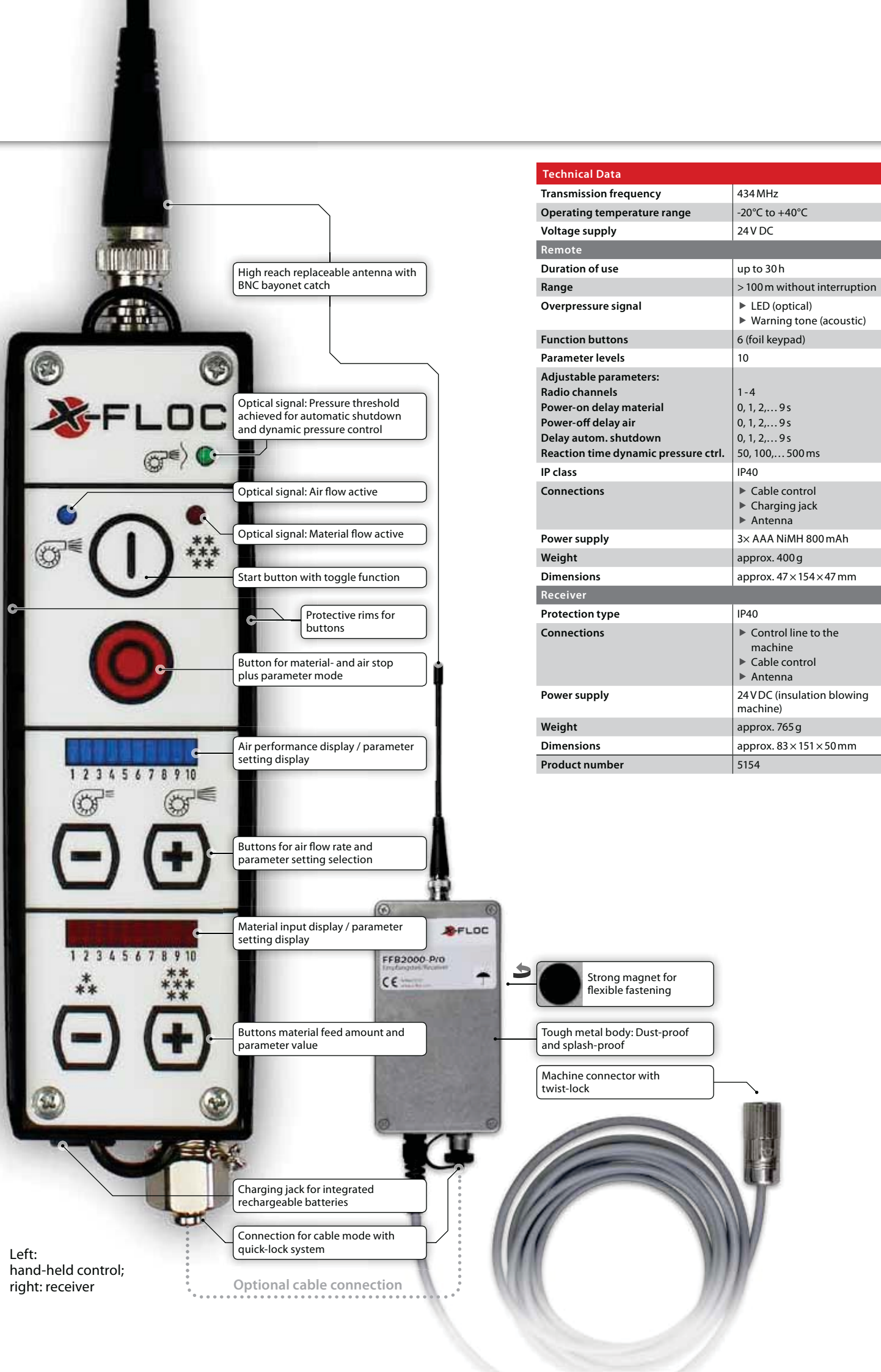

Technical Data

Transmission frequency	434 MHz
Operating temperature range	-20°C to +40°C
Voltage supply	24V DC
Remote	
Duration of use	up to 30 h
Range	> 100 m without interruption
Overpressure signal	► LED (optical) ► Warning tone (acoustic)
Function buttons	6 (foil keypad)
Parameter levels	10
Adjustable parameters:	
Radio channels	1 - 4
Power-on delay material	0, 1, 2,... 9 s
Power-off delay air	0, 1, 2,... 9 s
Delay autom. shutdown	0, 1, 2,... 9 s
Reaction time dynamic pressure ctrl.	50, 100,... 500 ms
IP class	IP40
Connections	► Cable control ► Charging jack ► Antenna
Power supply	3× AAA NiMH 800 mAh
Weight	approx. 400 g
Dimensions	approx. 47 × 154 × 47 mm
Receiver	
Protection type	IP40
Connections	► Control line to the machine ► Cable control ► Antenna
Power supply	24VDC (insulation blowing machine)
Weight	approx. 765 g
Dimensions	approx. 83 × 151 × 50 mm
Product number	5154

Left:
hand-held control;
right: receiver

Optional cable connection



Amplifier/Vacuum Stations

Type	VS28	VS33	VS55
Product number	2711	5855	6348
Amplification/Cleaning	✓ / ✓	✓ / ✓	✓ / ✓
Active dust removal	✓	✓	✓
Stepless performance regulation	✓	✓	✓
Operation with/without remote control	✓	✓	✓
Synchronisation with machine	✓	✓	✓
Power	2,8 kW	3,3 kW	5,5 kW
Max. overpressure	320 mbar	350 mbar	410 mbar
Max. negative pressure	280 mbar	320 mbar	360 mbar
Max. air blow volume (nom./measured)	440 / 360 m³/h	420 / 400 m³/h	470 / 460 m³/h
Air feed unit	High-powered radial compressors	High-powered radial compressors	Turbine
Blowing machine compatibility	Outlet pressure ≤ 320 mbar	Outlet pressure ≤ 400 mbar	Outlet pressure ≤ 400 mbar
Noise pressure level	80 dB(A)	78 dB(A)	95 dB(A)
Outlet connection/intake socket	NW63 (2½") / NW75 (3")	NW63 (2½") / NW75 (3")	NW63 (2½") / NW75 (3")
Operating hours meter	-	✓	-
Dimensions (LxWxH)	482 x 365 x 418 mm		785 x 700 x 580 mm
Weight	23 kg	23 kg	100 kg
Other features	<ul style="list-style-type: none"> ► Complete separation of working and cooling air ► Easily replaceable air filter mats ► Suction function: Suitable for a number of materials 		<ul style="list-style-type: none"> ► Complete separation of working and cooling air ► Simple maintenance ► Fast air filter maintenance by air filter cartridge ► Suction function: Suitable for a number of materials



Trailers, containers and transportation vehicles upon your enquiry

- ▶ Customized vehicle construction
- ▶ Handcrafted and longlasting products
- ▶ Individual planning
- ▶ Suitable for long and short distances
- ▶ Can be delivered with your adverts

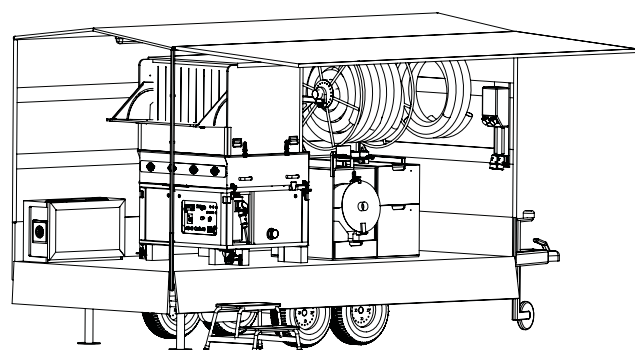

Container



Tarpaulin Cover



1-axel Box Trailer



2-axel Box Trailer

X-Floc partner

X-Floc Dämmtechnik-Maschinen GmbH

Rosine-Starz-Straße 12
71272 Renningen · Germany
Phone + 49 - 7159 - 80470 - 30 · Fax - 40
info@x-floc.com · www.x-floc.com

For prices, see current price list · Published 01.2017
We accept no responsibility for errors or changes.
PDF: www.x-floc.com/download